

4

3

2

1

D

D

C

C

B

B

A

A

192 POWDER COATED  
COLOR OPTIONS TO  
CHOOSE FROM

LASER CUT DOOR  
SKINS FOR SEALABLE  
DOORS

STAINLESS STEEL HINGES

MORTISED STAINLESS STEEL  
/ BRASS FINGER LATCH ASSEMBLY

PRE-HUNG 3" x 3" ANGLE  
IRON DOOR FRAME

OPTIONAL HIGH DENSITY  
POLYETHYLENE OR EXOTIC  
HARDWOOD LUMBER

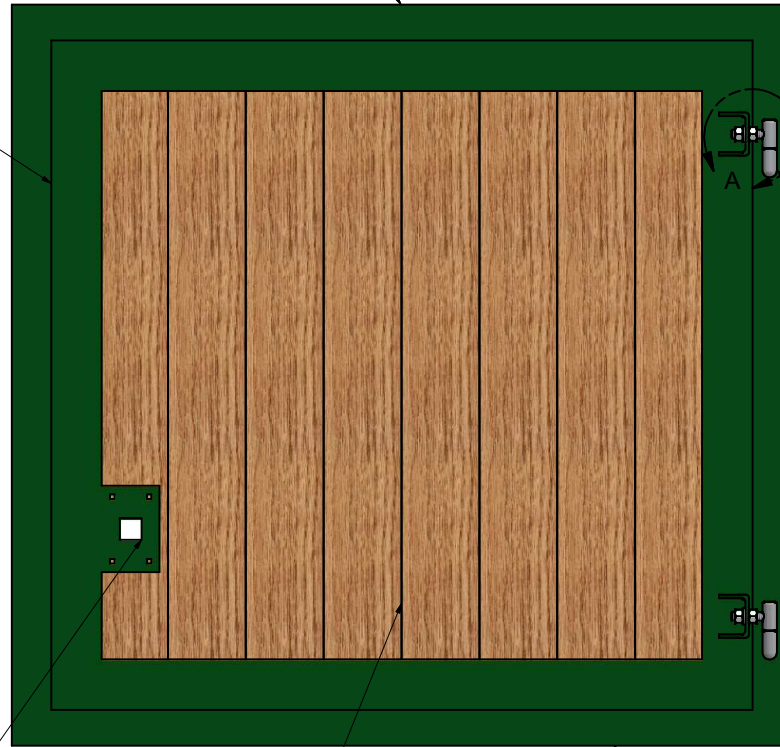
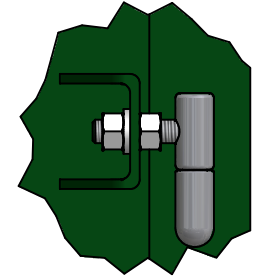
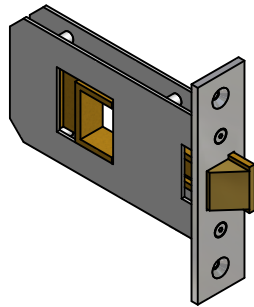

This schematic drawing is sent as a courtesy to our clients and is a copy righted and proprietary design owned by Innovative Equine Systems. Photocopying or reproduction of any kind or use in production, pre-production or quotation for production without the written consent of Innovative Equine Systems is prohibited. This is not a working shop drawing, and dimensions may or may not be accurate for any given project.

PRODUCED BY:	
LBC Product Design 908 Edna Court Rohnert Park, CA 94928 (707)206-9344 Bruce Coats	
MFG	5/17/05
CHECKED	

Innovative Equine Systems  
www.equinesystems.com  
800-888-9921

TITLE  
**EXTERIOR SHUTTER**

SCALE	DWG NO	SHEET	OF
		1	1